

2010 – 2011 Most Endangered Places

Blackwater Draw Locality #1, 508 NM 467, Portales, Roosevelt County

- AKA Clovis Site (LA3324); *type-site* for oldest undisputed culture in North America where association of humans with mammoths established.
- NW quarter owned by Mitchell Dairy, use land for pasturing cows; S half managed by state land office, leased for ranching activities; NE quarter managed by ENMU, open to public and research facility for university.
- On national register; National Historic Landmark.
- Extensive and detailed stratigraphic record threatened by ranching operations, erosion, prairie dogs, looting.



Figure 1. Erosional damage, view to southwest.



Figure 2. Active prairie dog damage.



Figure 3. Erosional slumping and fence collapse, view to southwest.



Figure 4. Stable, corrals, and trenches over known Paleoindian cultural materials, view to south.

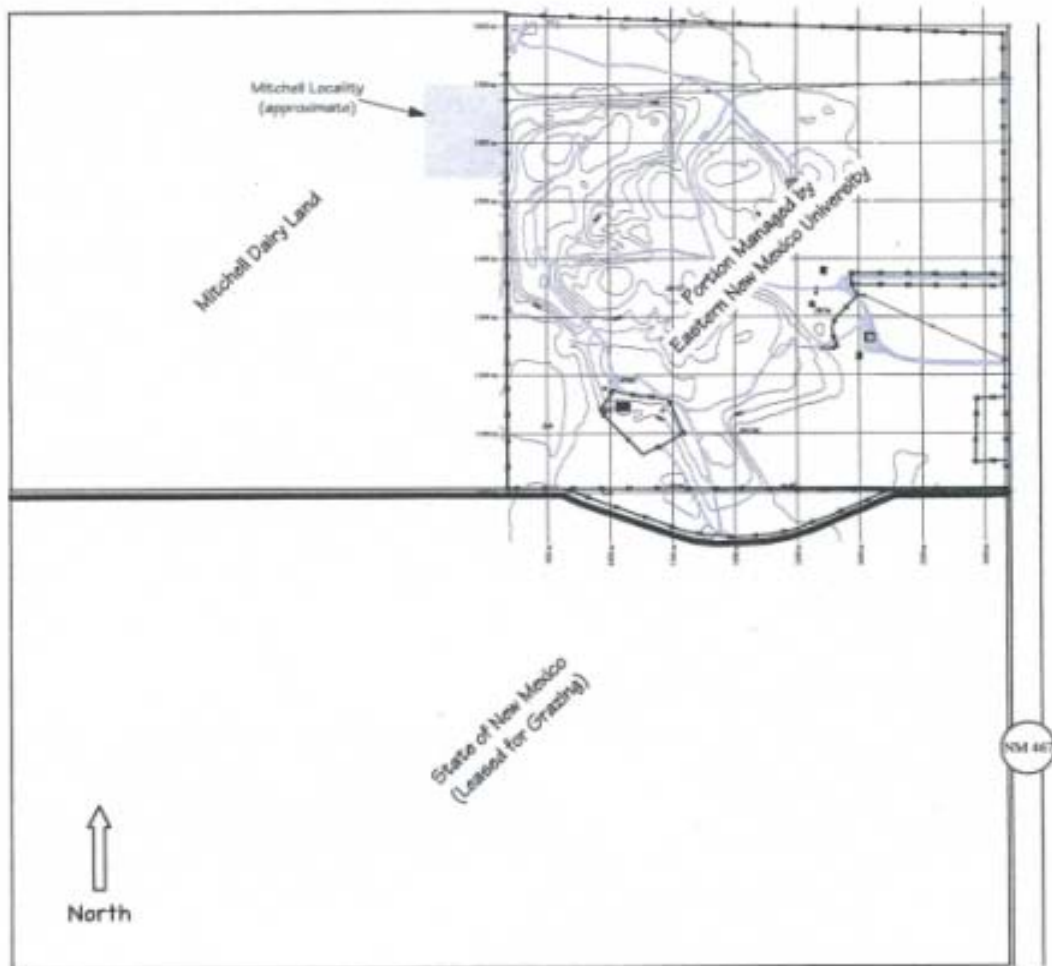

Figure 5. Map of Blackwater Draw Locality No. 1 (LA3324). Identified areas are included in the present nomination.
 Image adapted from *Blackwater Draw Locality No.1 Master Plan*, Crawford 1999.